

VetGlu

Add: A2-1 OF # 5 PLANT , NO.96 MUJIN ROAD, NINGBO
HIGH-TECH ZONE, NINGBO CITY, ZHEJIANG PROVINCE.

Tel: +86-574-8756 4800

Fax: +86-574-8756 4717

E-mail: sales@perfectseal.com

Http: www.perfectseal.com

VetGlu[®]

PATS TISSUE ADHESIVE

ZHEJIANG PERFECTSEAL NEW MATERIAL
TECHNOLOGY CO.,LTD



Is a pet-grade tissue adhesive that can replace sutures after animal surgery.



PVG-01 3ml/pcs

Features:

The blue color is easy to see the part where the biological tissue glue has been applied. In a few seconds, the product turns from a liquid into a solid state to close the wound and stop bleeding.



Safe and Quick



Waterproof



Bacteriostatic



No suture removal

Brush applicator easy to use

Is a pet-grade tissue adhesive that can replace sutures after animal surgery.

PVG-02 2g/pcs

Features:

The blue color is easy to see the part where the biological tissue glue has been applied. In a few seconds, the product turns from a liquid into a solid state to close the wound and stop bleeding.



Safe and Quick



Waterproof



Bacteriostatic



No suture removal

Tapered bottle mouth for easy use



Application:

It is used to bond tissues after pet surgery, such as: lacerations, abrasions and other wounds, to strengthen the additional stability of sutures and nails, often used in tooth extraction and oral surgery. Pet ovary removal and sterilization surgery, residual toe removal, eye surgery.

Lacerations and Abrasions

Oral Surgery

Sterilization Operation

Residual Toe Excision

Eye Surgery

Instructions:

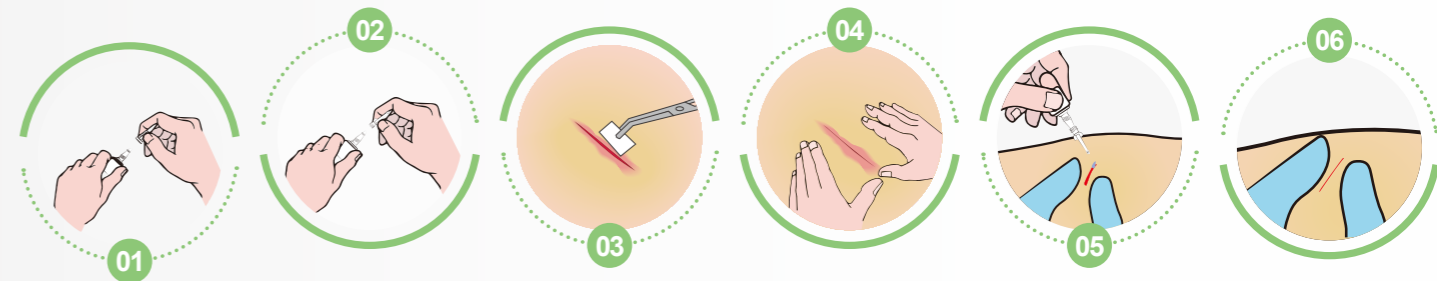

Pets tissue adhesive must be at room temperature before use.

1. Remove the cap.
2. Attach the applicator and push it into place.
3. Point the tip of the applicator at the patient and apply a small amount of tissue adhesive to the surface in a thin layer. Applying too thickly will cause the adhesive to crack prematurely, bringing the skin edges together for 5-10 seconds. Applicator tip Avoid contact with wet surfaces and do not apply pet biological tissue glue inside or under the epidermis.
4. After the procedure is complete, check for bleeding. If necessary, re-drop the adhesive on the edge of the wound.